

ISSUED FOR SITE PLAN REVIEW 28 JULY 2000



DESIGNED BY CRAVEN	DATE JULY 00
DRAWN BY LDW & GC	DATE JULY 00
CHECKED BY GC	DATE JULY 00
EDIT	FILE
SCALE	
VARIES	
DRAWING	
PLOT	
PROJECT 9907	
A2.0	
SHEET NO	

[illegible]

© 2000 D. S. WRIGHT & ASSOCIATES, P.C.
D. S. WRIGHT & ASSOCIATES, P. C.
ARCHITECTURE & PLANNING
44456 CLARE BLVD, PLYMOUTH, MICHIGAN 48170
TELEPHONE • 734 377-4632
CONSULTANT

THIS DRAWING IS CONDITIONALLY ISSUED AND
REPRODUCTION OR USE OF ITS CONTENT IS
FORBIDDEN WITHOUT SPECIFIC WRITTEN
PERMISSION.

DRAWING TITLE:	
Composite Floor Plan	
PROJECT:	New Building for JSB Builders LLC
ADDRESS:	6032 Schooner Road Van Buren Township, MI 48111
DO NOT SCALE THIS PRINT. USE FIGURED DIMENSIONS ONLY.	
DRAWN:	DSW
CHECKED:	
PLOT DATE & TIME:	
Mar 11, 2021 - 8:12am	
DRAWN DATE :	09/02/2020
PROJECT NUMBER:	20-489.00
SHEET NUMBER:	A - 210

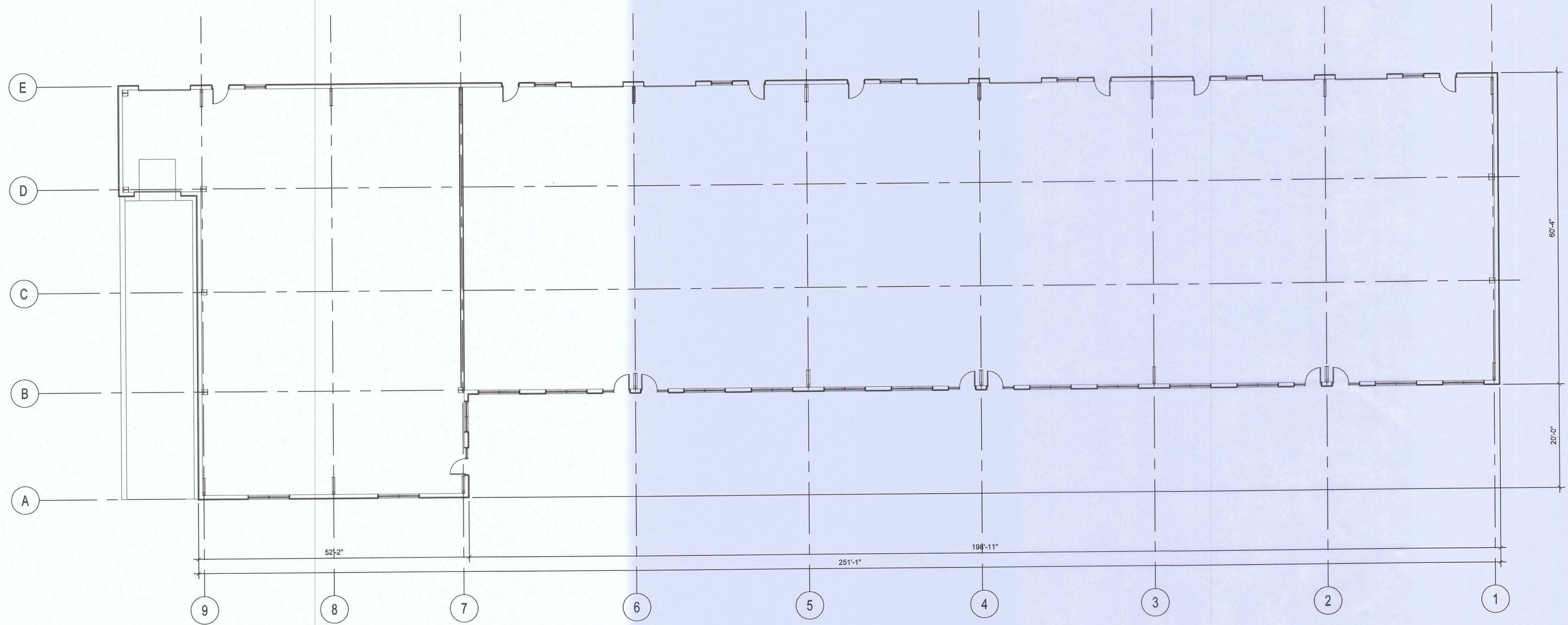

COMPOSITE FLOOR PLAN
SCALE: 3/32" = 1'-0"

PRELIMINARY

LIGHT FIXTURE SCHEDULE

F = FLUORESCENT I = INCANDESCENT H = HIGH INTENSITY DISCHARGE O = OTHERS									
TYPE	LAMP F I H O	LAMP QUANTITY AND CODE	MOUNTING	DIFFUSER	MANUFACTURE AND CATALOG NUMBER	VOLTS	DESCRIPTION	REMARKS	
A	●	3-F40CW12	RECESSED	ACRYLIC WH.	LITHONIA 2GT332A121201/3GEB	120			
B	●	2-F80CW12	CHAIN		LITHONIA	120			
C	●	1-70W MTL. HLD.	SURFACE	ACRYLIC WH.		120	GENERIC, U.L. LISTED	ALUM. WALL PACK W/ PHOTOCELL, WIRED TO EMERGENCY CIRCUIT.	
D	●	1-150W	RECESSED	POL. ALUM.	LITHONIA OR HALO	120	CAN TYPE W/ LENS	W/ PHOTOCELL, WIRED TO EMERGENCY CIRCUIT.	
EM	●	-	WALL MTD		LITHONIA LHOMSW3R120/277N	120			

LEGEND

- DUPLEX RECEPTACLE

● 2G DUPLEX

● SPECIAL SING. RECEPTACLE

● GFCI DUPLEX

W WEATHER-PROOF
- DEDICATED DUPLEX RECEPTACLE

▶ TELEPHONE OUTLET

‡ SINGLE POLE SWITCH

3 3-WAY SWITCH

Q JUNCTION BOX (AS NOTED)
W/ HT. ABOVE FINISH FLOOR

● ROOF-TOP JUNCTION BOX; MAKE
THE CONNECTIONS TO THE HVAC UNIT.
- LOW BAY METAL HALIDE

EM EXIT AND EMERGENCY LIGHT

W EXTERIOR WALL PACK

CH CHAIN HUNG FLUORESCENT

RECESSED FLUORESCENT

ROOM VENTILATION FAN (VENT THRU WALL)
INTERCONNECT REST ROOM FAN WITH LIGHTS

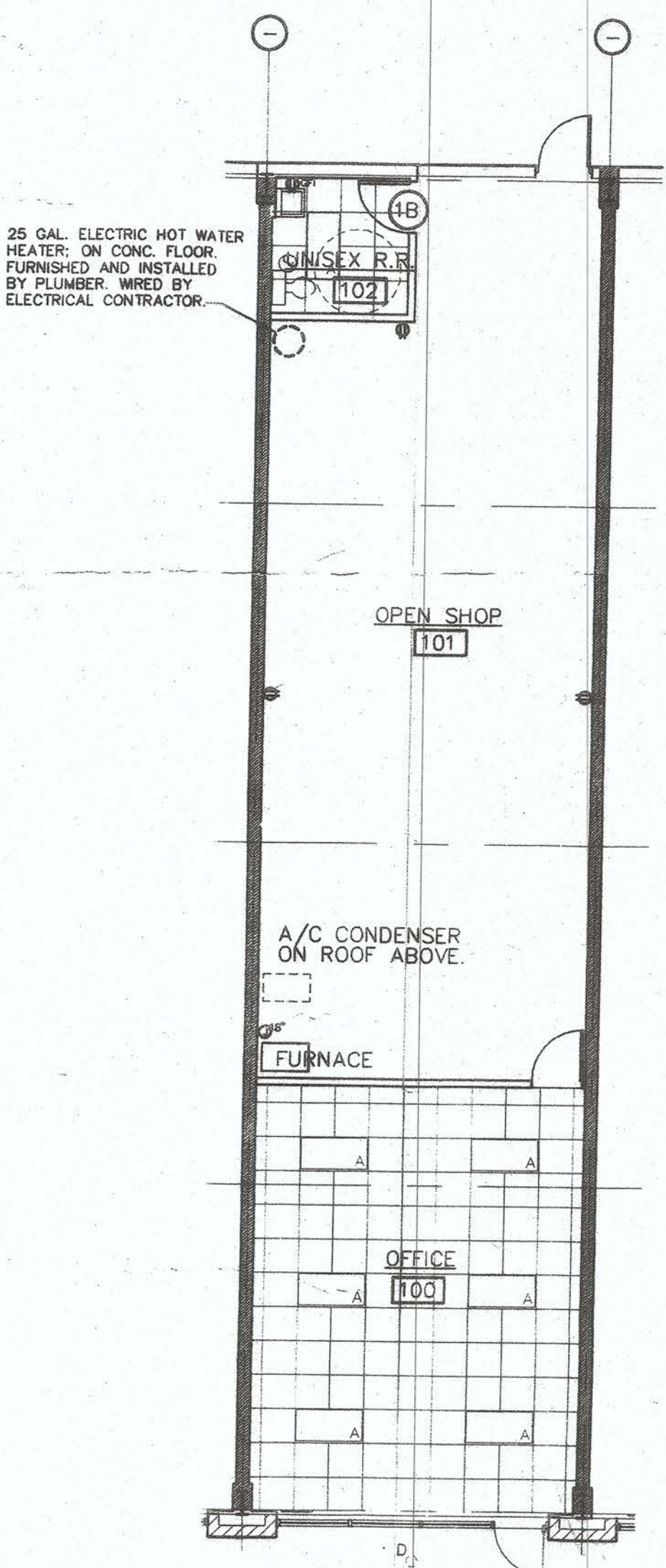

MECHANICAL PLAN

SCALE

NOTE:
THE ELECTRIC WATER HEATER IS TO BE FURNISHED AND INSTALLED BY THE PLUMBER, BUT WIRED BY THE ELECTRICAL CONTRACTOR. INSTALL THE WATER HEATER ABOVE THE CEILING OVER THE REST ROOM. SUPPORT THE HEATER ON A UNISTRUT PLATFORM RATED FOR THE HEATERS WEIGHT.

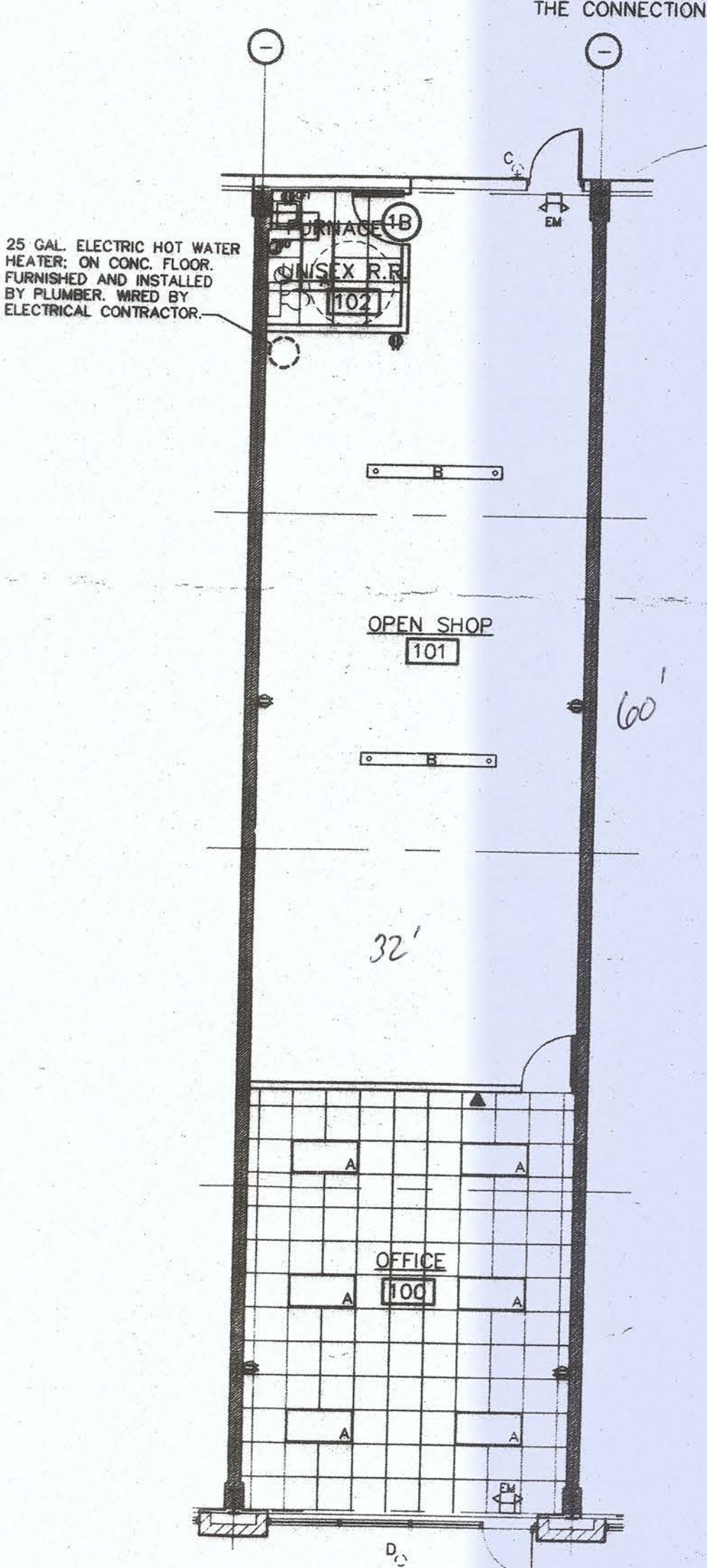

ELECTRICAL AND REFLECTED CEILING PLAN

SCALE

NOTE:
THE CONTRACTOR IS TO FURNISH ALL MATERIALS AND LABOR NECESSARY FOR A COMPLETE WORKING FACILITY. THE SCOPE OF THE ELECTRICAL WORK IS TO INCLUDE, BUT NOT LIMITED TO, ALL WIRE, CONDUIT, TRANSFORMERS, SWITCH GEAR, FIXTURES, STARTERS, CONTROL WIRING, DUCTS, HANGERS, PANELS, AND RECEPTACLES. ALL PERTINENT CODES AND ORDINANCES ARE TO BE STRICTLY FOLLOWED, INCLUDING CITY, COUNTY, STATE, AND FEDERAL.

THE ELECTRIC WATER HEATER IS TO BE FURNISHED AND INSTALLED BY THE PLUMBER, BUT WIRED BY THE ELECTRICAL CONTRACTOR. INSTALL THE WATER HEATER ABOVE THE CEILING OVER THE REST ROOM. SUPPORT THE HEATER ON A UNISTRUT PLATFORM RATED FOR THE HEATERS WEIGHT.

NTS

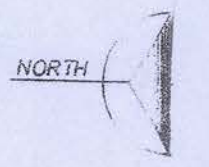

CONSTRUCTION NOTES:

1. ALL WALLS SHOWN AS 5/8" TYPE 'X' DRYWALL. CONSTRUCT ALL WALLS TO SIZES, UNLESS OTHERWISE NOTED.
2. THE WALLS WHICH SEPERATE THE REST ROOM FROM THE OFFICE ARE TO BE 16" D.C. AND ARE TO BE CONSTRUCTED AS PER THE ARCHITECT'S REQUIREMENTS.
3. ALL WALLS SHOWN AS 5/8" TYPE 'X' DRYWALL. CONSTRUCT ALL WALLS TO SIZES, UNLESS OTHERWISE NOTED.